

**Vue B
View**

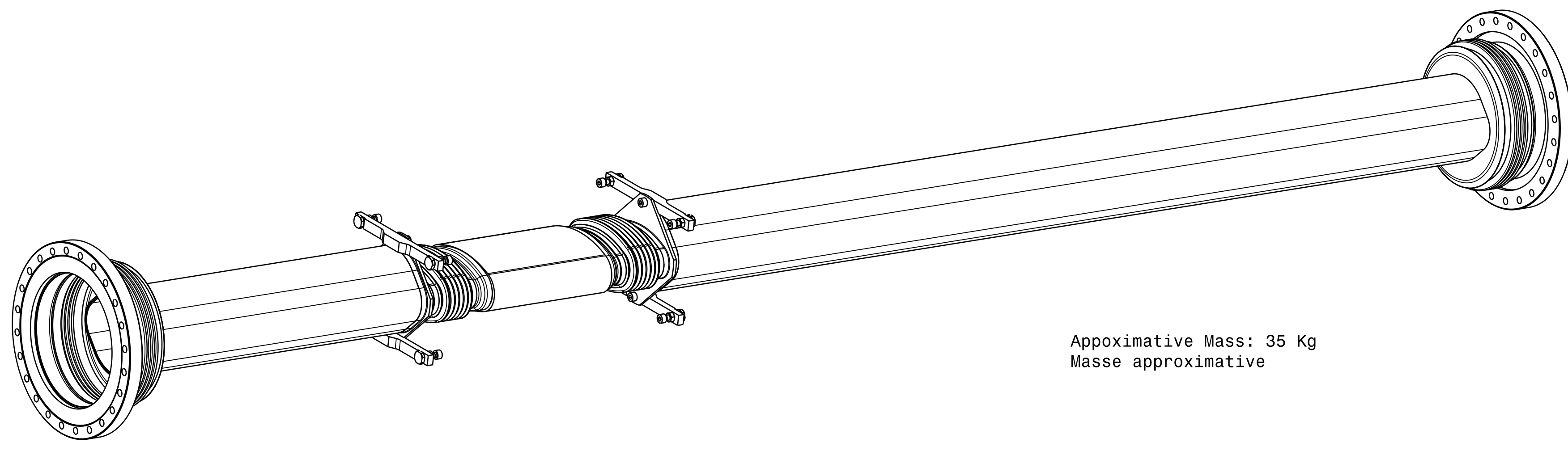

Approximative Mass: 35 Kg
Masse approximative

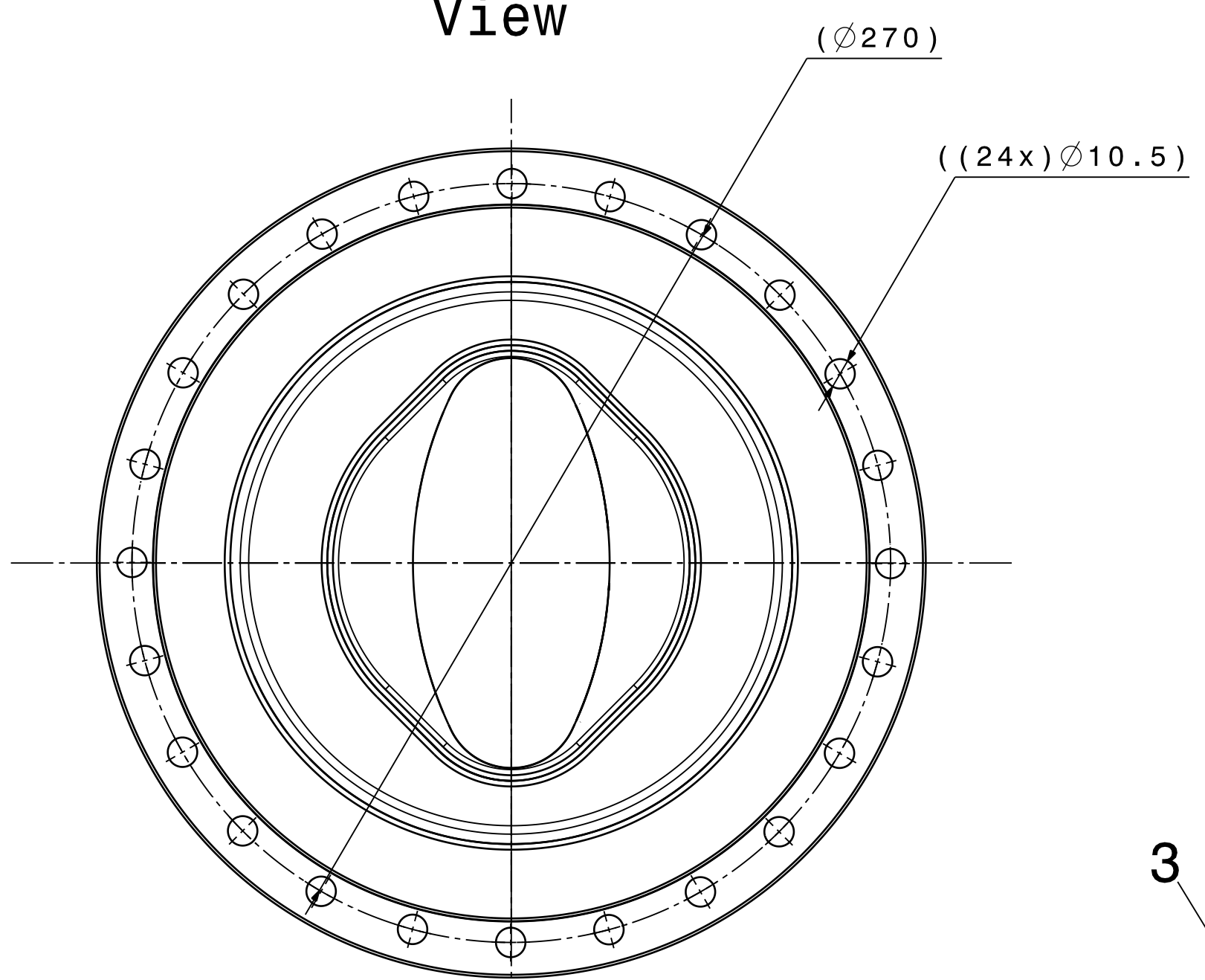
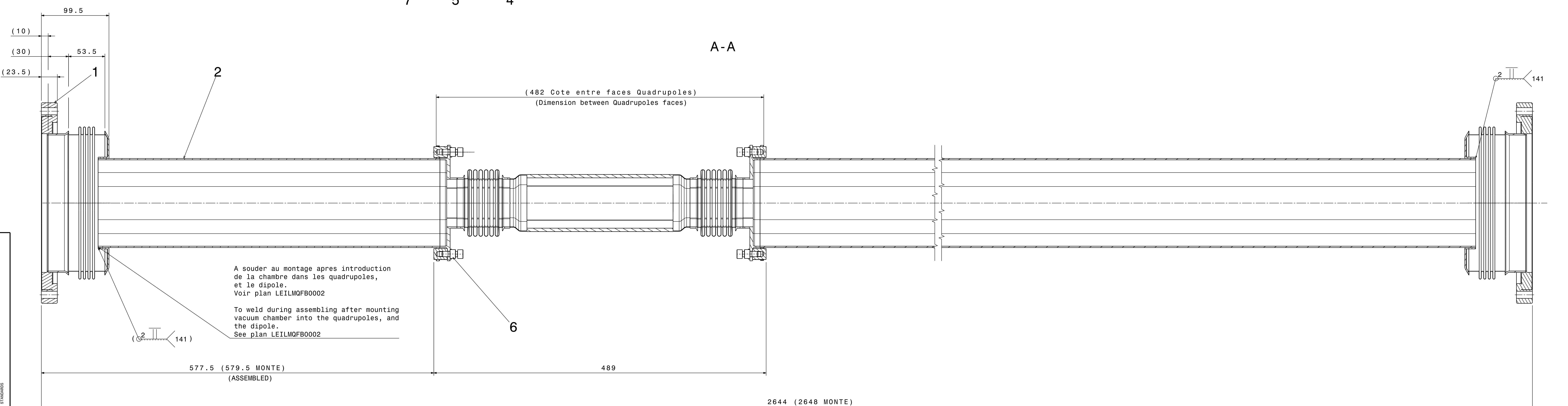
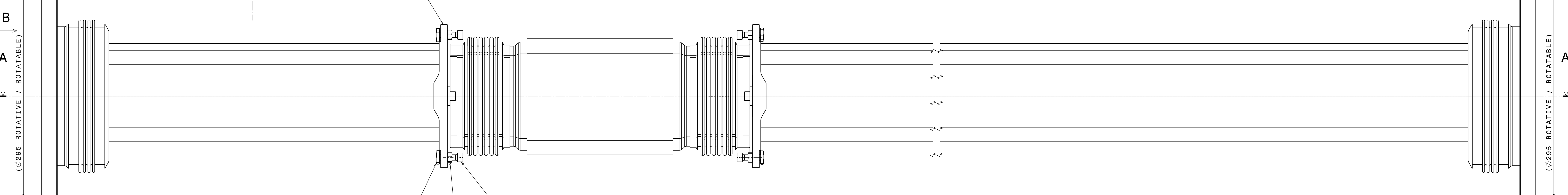

A souder au montage apres introduction de la chambre dans les quadrupoles, et le dipole.
Voir plan LEILMQFB0002
To weld during assembling after mounting vacuum chamber into the quadrupoles, and the dipole.
See plan LEILMQFB0002

Information
Inscribe drawing number on shades area with an electrical pen
Inscrire le numero de detail sur une zone predefini avec un stylo electrique

Cleaning / Nettoyage
According procedure / Suivant procedures de L. Ferreira, CERN Reports : Procedure Qualite 867.11, 867.15, 876.16 (2003)

Vacuum firing / Traitement Thermique
600°C for 24H / 600°C pendant 24H

NEG coating / Depot NEG
Coating with 2 μm Ti-Zr-V / Dépôt de 2 μm de Ti-Zr-V

Note / Nota :
Protect the ceramic during the removal of the NEG
Protéger la céramique lors de la dépose du NEG

This drawing represents a part (or a component) of the vacuum system for LEIR with will operate at 10-10 Pa (10-12Torr). All welds must be made using the specified technics with 100% penetration. Welds and all other surfaces must not be finished by grinding or any other mechanical abrasion. Any part (or component) of the vacuum system showing a room temperature leak rate (localized or global), when measured with a calibrated UHV leak detector, in excess of 1x10-11 Pa m3 s-1 (7.5x10-11 Torr 1s-1) will be considered as unacceptable.

Ce dessin represente une partie (ou composant) du systeme a vide LEIR qui fonctionnera a 10-10 Pa (10-12 Torr). Toutes les soudures seront realisees selon le procede specifique avec penetration de 100%. Ces soudures ne doivent etre ni meulees ni abrasees. Toute partie (ou composant) du systeme a vide ayant un taux de fuite (local ou global), qui est mesure a l'aide d'un detecteur de fuite UHV, superieur a 1x10-11 Pa m3 s-1 (7.5x10-11 Torr 1s-1) sera considere comme inacceptable.

QTY	DESCRIPTION	POS	MAT.	S. ENS/S.S. ASS	OBSERVATIONS	REF. CERN
8	ISOLATING CONTACT	7	SILK FIBRE	LEIVCOLB0007		
	CONTACT ISOLANT		FIBRE DE SOIE			
4	SOCKET HEAD SCREW M8x12	6	ST. STEEL	BOSSARD 1127047		
	VIS CHC M8x12		AC. INOX			
8	HEXAGONAL NUT M8	5	ST. STEEL		47.43.77	
	ECROU HEXAGONAL M8		AC. INOX		080.3	
8	SOCKET HEAD SCREW M8x30	4	ST. STEEL		47.62.71	
	VIS CHC M8x30		AC. INOX		311.3	
4	CONTACT BAR	3	ST. STEEL	LEIVCOLB0006		
	BARRE DE CONTACT		316LN			
1	VACUUM CHAMBER	2	ST. STEEL	LEIVCOLG0002		
	CHAMBRE A VIDE		316LN			
2	EXTREMITY OF QUADRUPOLE	1		E43.1045		
	EXTREMITE DE QUADRUPOLE					

TOLERANCES DIMENSIONS	Tolerances geometriques, lineaires et angulaires	ISO 2768-mK-E
	Arêtes de forme non definies	ISO 13715 ± 0.3 ± 0.3

LEI Vacuum Chamber for Quadrupole (stage 1) part 01	EGHELLE SCALE	1:2	DES. DRA. CONTROLLED	ACROTECHNA	2006-07-18
QUADRUPOLES STACK VACUUM CHAMBER			APPROVED		
STACK DE QUADRUPOLES CHAMBRE A VIDE			REPLACE/REPLACES	LEIVCOLG01	LEIVCOLG0001
NON VALABLE POUR EXECUTION NOT VALID FOR EXECUTION			DATE	0	