

Approximative mass : 0.5 kg
Masse approximative

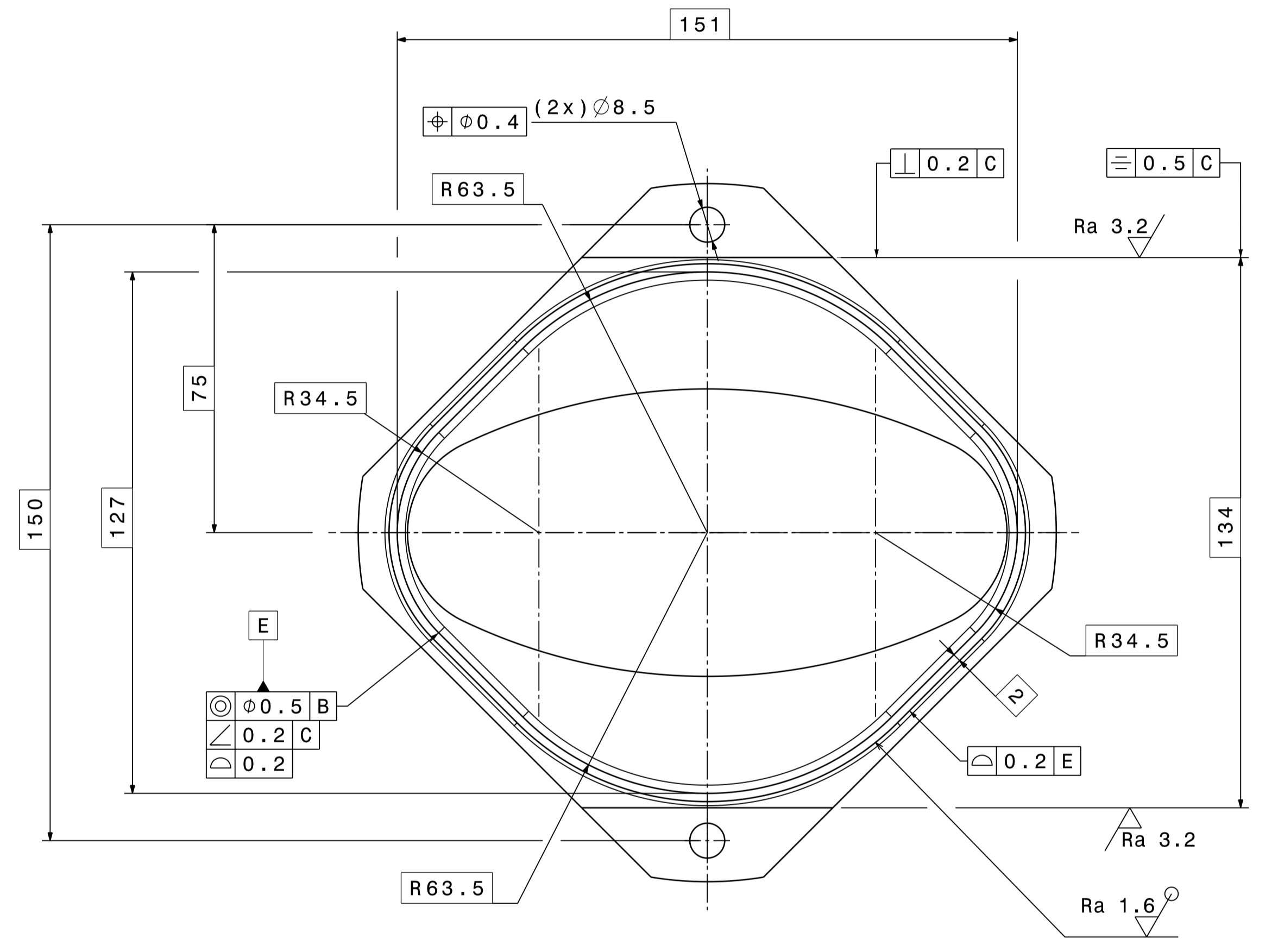

Cutting of the material : Ra 6.3 /
Decoupees des matieres

Cleaning / Nettoyage
According procedure / Suivant procedures de
L. Ferreira, CERN Reports : Procedure Qualite 867.11,
867.15, 876.16 (2003)

Vacuum firing / Traitement Thermique
950°C for 2H / 950°C pendant 2H

Ra 6.3 / Ra 3.2 / Ra 1.6 /

TOLERANCES GÉNÉRALES "TOLERANCES GÉNÉRALES"	Tolerances geometriques, lineaires et angulaires	ISO 2768-mK-E
	Aretes de forme non definies	ISO 13715 ± 0.3 ± 0.3

1	ROUND BAR Ø201mm	1	ST. STEEL	LENGTH 35 mm	44.57.10
	ROND Ø201mm		316LN	LONGUEUR 35 mm	368.1
QUANT.	DESCRIPTION	POS.	MAT.	OBSERVATIONS	REF. CERN
ENS/ASS	S. ENS/S. ASS				
LEIR Vacuum Chamber for Quadrupoles Lozenge-shaped (Variant B)				ECHELLE SCALE	DES/DRA. ACROTECNA 2006-07-07
VACUUM CHAMBER TRANSITION PART CHAMBRE A VIDE PIECE DE TRANSITION				CONTROLLED	
				RELEASED	
				APPROVED	
				LEI\VCQLB0\LEIVCQLB0005	
				REPLACE/REPLACES	
NON VALABLE POUR EXECUTION NOT VALID FOR EXECUTION				GAC -	SIZE IND. LEIVCQLB0005 1

ORGANIZATION EUROPEENNE POUR LA RECHERCHE NUCLEAIRE
 EUROPEAN ORGANIZATION FOR NUCLEAR RESEARCH
 DESIGN, DRAUGHTING, TOLERANCES, DIMENSIONS
 DRAWING, RUGOSITY, TOLERANCES
 ACCORDING TO ISO STANDARDS
 PROJECTION
 LEI